

PUMP ACCESSORIES

www.BLACKMER.com

SECTION D  
PUMP ACCESSORIES

Blackmer Pump Parts List  
Models: LGF1C, LGB1C, LGF1PC and LGB1PC

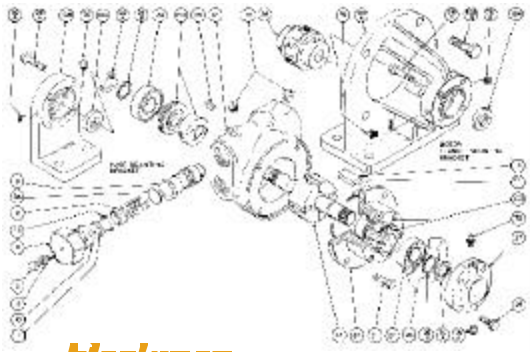

REF. NO.	PARTNAME	PARTS PER PUMP	PART NUMBER
2	AdjustingScrew-R/V	1	432901
3	Locknut-AdjustingScrew	1	922811
4	Cover-R/V	1	412901
4 A	O-Ring-SpringGuide	1	711940
7	SpringGuide-R/V	1	422901
8	Spring-R/V	1	472901
9	Valve-R/V	1	452901
9 A	Disc-R/V	1	442901
10	O-Ring-R/VCover	1	701965
12	Cylinder-LGF1, LGB1	1	022902
12	Cylinder-LGF1P, LGB1P	1	022911
13	Rotor&ShaftAss. (includes#24A)	1	262901
14	Vane-Duravane(Std.)	4	092912
14	Vane-Laminate	4	092909
20	Head	1	032902
21	Capscrews-Head	4	920178
24	BallBearing	2	903405
24A	Locknut-Bearing	2	903531

REF. NO.	PARTNAME	PARTS PER PUMP	PART NUMBER
24B	Lockwasher-Bearing	2	903532
26	Gasket-BearingCover	1	382901
27	BearingCover	1	042901
28	Capscrews- BearingCover	4	920203
28A	MountingScrews	4	920230
34	CouplingHalf-Pump	1	906139
34	CouplingHalf- Motor(143T,145T,184)	1	906143
34	CouplingHalf- Motor(56,56C)	1	906141
34	CouplingSpider	1	906154
35	Key-Shaft	1	909126
72	O-Ring-Head	1	711941
73	GagePlug	2	908195
76	GreaseFitting	2	317815
76A	GreaseReliefFitting	2	701992
104	GreaseSeal	1	331934
108	Bracket-LGB1&1P	1	832901
108A	Bracket-LGF1&1P	1	832905
108B	Capscrews-Bracket	4	920331

Blackmer Pump Parts List  
Model: TLGLF3C

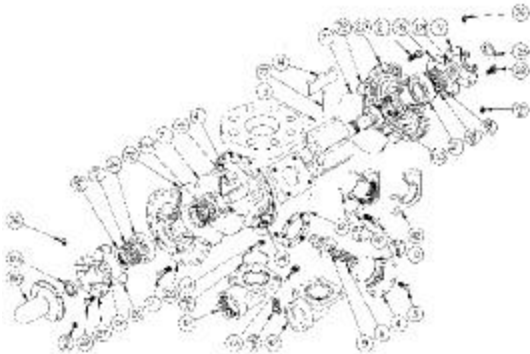

REF. NO.	PARTNAME	PARTS PER PUMP	PART NUMBER
4	Cover-ReliefValve(R/V)	1	415108
5	Capscrew-R/VCover	6	920331
8	Spring-R/V	1	471428
9	Valve-R/V(Std.)	1	451417
9	Valve-R/V(NickelPlated)	1	451415
10	O-Ring-R/VCover	1	701919
12	Casing	1	015128
13	Rotor&ShaftAss. (includes#24A)	1	265147
14	Vane-Duravane	6	095132
20	Head	2	035132
21	Capscrews-Head	36	920351
24	BallBearing	2	903156
24A	Locknut-Bearing	2	903521
24B	Lockwasher-Bearing	2	903522
26	Gasket-BearingCover	2	383940
27	BearingCover	2	041431
28	Capscrews-BearingCover	8	920285
35	Key-Shaft	1	909130

REF. NO.	PARTNAME	PARTS PER PUMP	PART NUMBER
41	Liner	1	185101
42	Flange-2"NPT	12	652010
42	Flange-2"Weld	12	652011
42	FlangedElbow-2"NPT	12	655100
42	FlangedElbow-2"Weld	12	655109
42A	O-Ring-Flange	2	701919
42B	Capscrew-Flange	8	920491
71	Disk	2	065121
72	O-Ring-Head	2	711923
73	GagePlug	2	908195
74	Key-Liner	1	185193
76	GreaseFitting	2	317815
76A	GreaseReliefFitting	2	701992
77	PushRod	3	121607
104	GreaseSeal	2	331918
123	DirtShield	2	701480
186	ShaftProtector	1	341601

Pump Maintenance Kits



By installing a maintenance kit in your old Blackmer Pump, you can obtain like new performance and extended service life.

FOR PUMP MODEL	PART NUMBER	LIST PRICES
LGFC, LGBIC, LGF1PC, LGB1PC	898916	547.20
LGRL1-1/4, LGR1F1-1/4	898917	547.20
LG1-1/4, LG1-1/2, LGL1-1/4, LGLF1-1/4, LGL125	898918	547.20
LGL1-1/2, LGL150	898919	547.20
LGL2E, TLGLD2E, LGLD2	898920	1006.20
LGL3E, TLGLD3E, LGLD3	898921	1342.80
TLGLF4A, LG4C, TLGFD4, LGL4, LGLD4	898922	1526.40
TLGLF3C	898923	1281.60

Blackmer Rebuild Kits



FOR PUMP MODEL	PART NUMBER	LIST PRICES
LGRLF1.25A with Rotor and Shaft, Liner (LPG)	899017	1251.00
LGLF1.25A with Rotor and Shaft, Liner (LPG)	899018	1251.00
LGLF1.5A with Rotor and Shaft, Liner (LPG)	899019	1251.00
LGLD2E with Rotor and Shaft, Liner (LPG)	899020	1526.40
LGLD3E with Rotor and Shaft, Liner (LPG)	899021	2196.00
LGLD4 with Rotor and Shaft, Liner (LPG and NH3)	899022	3897.00

FOR PUMP MODEL	PART NUMBER	LIST PRICES
TLGLF3C with Rotor and Shaft, Liner (LPG)	899023	1989.00
LGRLF1.25A with Rotor and Shaft, Liner-8Vane (LPG)	899076	1251.00
LGLF1.25 with Rotor and Shaft, Liner-8Vane (LPG)	899077	1251.00
LGL1.5 with Rotor and Shaft, Liner-8Vane (LPG)	899078	1251.00
LGLD2E TLGLD2E with Rotor and Shaft, Liner (NH3)	899079	1434.60
TLGLF3C with Rotor and Shaft, Liner (NH3)	899080	2196.00
LGLD3E TLGLD3E with Rotor and Shaft, Liner (NH3)	899081	2295.00

Blackmer Bypass Valves



Blackmer has five different bypass valves to handle the full pumping capacity of any liquefied gas pump. All are suitable for both LP-Gas and anhydrous ammonia service.

STANDARD PRESSURE SETTING	MODEL DIFFERENTIAL PRESSURE SETTING (PSI)	MAXIMUM FLOW (GPM)	PART NUMBER	LIST PRICES
95 PSI	20, 50, 80, 120	25, 40, 50, 60	BV34	324.00
			BV1	338.60
115 PSI	20, 50, 80, 120	60, 80, 100, 125	BV114	458.46
			BV112	484.40
95 PSI	20, 50, 80, 120	150, 180, 220, 250	BV2	748.44